

66.

99.5

778.80
389.40

1540.94
760.50
2301.44

863.65
99.
4) 664.65
166.16
49.5
215.66
33
248.68

115.289
76233
122.9123
495
417
14
55.7

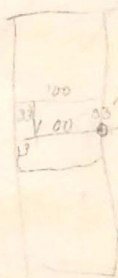

100.
76240
76653
115.28.9
35.5

115.644
114

115.78.4

5215.66
248.66

763.65
764.50
2) 152815
764.08

116.



847
764
7.64.5
7.63.65
2815
663.40
331.70
495
381.2

763.65
99.
4) 664.65
166.16
49.5
215.66